



Your unique meeting or convention deserves one of our unique locations. Named by Frommer's as a [must see destination](#), Asheville provides Southern hospitality and all the amenities needed to make your next meeting or convention successful.

Asheville provides a welcome escape from the daily grind to the resort-like atmosphere of the Blue Ridge Mountains paired with a vibrant and artsy downtown. Asheville is an easy drive from most of the Eastern United States, and is centrally located in the epicenter of numerous major cities, from Atlanta to New York and Cleveland to Jacksonville.

### Reasons to meet in Asheville

- Asheville is a vibrant city with a diverse mix of things to do such as outdoor adventures, art gallery hopping and fine and organic cuisine.
- Largest city in Western North Carolina.
- With 21,000 square feet of meeting space, the Asheville Renaissance Hotel is ideal for hosting a wide range of meetings from 5 to 500 people.
- Daily jet service from Asheville Regional Airport provides easy accessibility.
- If you're working with a modest meeting budget, reduced rates are offered from January through March.
- Take advantage of Marriott Rewards for Meeting Planners!

As Asheville's only full-service Marriott property, we are located in the heart of downtown Asheville within walking access to a multitude of activities. As of spring 2007, our 275 guest rooms have been completely and beautifully renovated to a brand new contemporary and modern, yet fun, look. With the goal of updating the entire hotel, we followed up and completed our meeting space renovation in spring 2008.

If your attendees are young-at-heart professionals who work hard and play hard or need a place to relax, downtown Asheville's eclectic boutique shopping, day spas, outdoor activities, galleries, restaurants and night-life offers the perfect remedy! Downtown Asheville is a place to be inspired, have fun and breathe deep in surroundings unlike any other.

The Asheville Renaissance Hotel is privately owned and operated under the Marriott brand by Windsor Capital Group out of California ([www.wcghotels.com](http://www.wcghotels.com)). Your sales and event staff are located onsite to assist with your every meeting need creating memorable and successful programs.

Hotel amenities include a 60-foot heated indoor pool and jacuzzi, Starbucks coffee, executive business center, well-equipped exercise facility, lobby lounge, gift shop and ample parking. In room amenities include 32" LCD flat screen televisions, iPod compatible alarm clocks, Starbucks coffee and tea service, in-room refrigerators and high-speed internet access.

31 Woodfin Street  
Downtown Asheville, NC 28801  
Fax: 828.236.9616  
Sales: 828.210.3009  
Toll Free: 800.359.7951



let your sense of adventure come out and play

[discover here >>](#)



**RENAISSANCE.**  
ASHEVILLE HOTEL



**General Room Amenities**

- Mountain and city views
- i-Pod compatible alarm clock
- Bottled water (Club Level)
- Starbucks coffee and tea service
- Electrical adapters
- Individual climate control
- Iron and ironing board
- Luxurious bedding - down comforters, custom duvets, cotton-rich linens
- Down and foam pillows
- Refrigerators
- Cribs and rollaway beds available
- Newspaper delivery

**Bathroom Amenities**

- Make up mirror
- Hair dryer
- Energy saving night light
- Curved shower rod
- Storage under vanity
- Bath mat
- Bathrobes (Club Level)

**Highlights**

- Plug In Panel connects laptop, MP3 player, digital camera & video game player to big screen LCD HDTV
- Wireless high-speed internet
- Handicapped rooms available
- Club level accommodations and amenities
- Lighted makeup mirrors
- 32 inch LCD HDTV flat screen TV

**Room Entertainment**

- Cable channel: CNN
- Cable channel: ESPN
- Cable channel: HBO
- Cable/satellite TV
- Movies/videos, pay-per-view

**Additional Services**

- Room Service
- Bellman Assistance
- 24-hour Fitness Center
- Indoor Heated 60-ft Pool
- Lobby Lounge
- Non-Smoking Facility
- Outdoor Patio

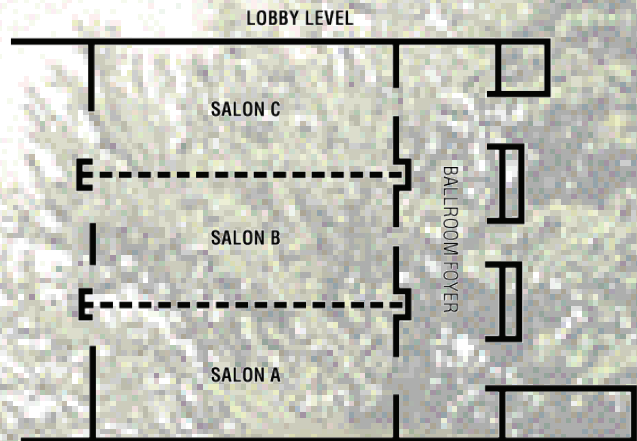
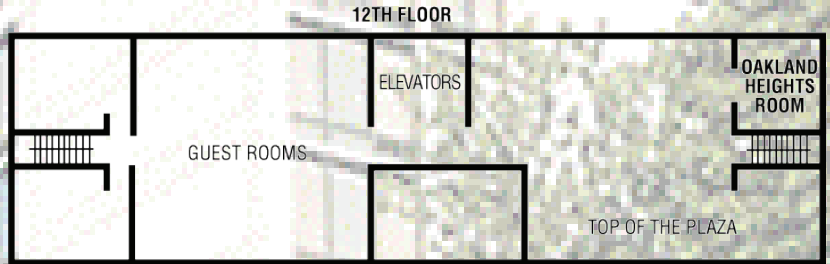
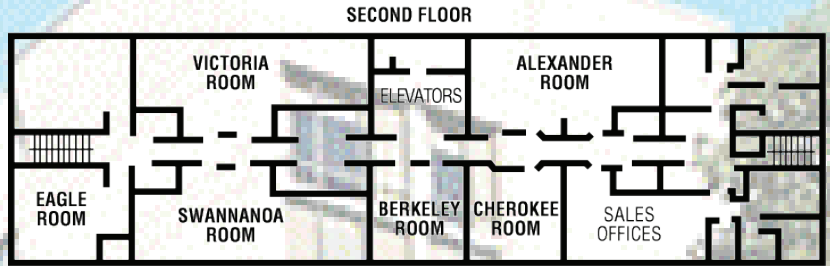

**Rewarding Events!**

Meeting planners receive credit for up to 50,000 Marriott Reward Points or 15,000 airline miles for placing your event with the Renaissance Asheville Hotel.

Visit [www.ashevillerenaissance.com](http://www.ashevillerenaissance.com) to become a member today

Meeting Room	LxWxH	Sq. Ft.	Theater	Classroom	Conference	U Shape	Reception	Banquet
Alexander	48x18x8	864	100	50	30	30	100	60
Victoria	48x18x8	864	100	50	30	30	100	60
Swannanoa	60x18x8	1,080	125	80	40	40	125	80
Berkeley	24x18x8	432	50	25	20	15	50	40
Cherokee	24x18x8	432	50	25	20	15	50	40
Eagle	27x24x8	648	40	25	20	15	50	40
Ballroom Salons A or C	34x38x12	1,300	100	60	30	30	125	90
Grand Ballroom	105x77x12	8,075	800	500			1000	600
Ballroom Foyer	20x102x14	2,040					200	
Oakland Heights	28x24x8	552	40	25	20	20	50	40
Top of the Plaza	18x79x8	1,422					200	120
Windsor Ballroom (not shown)	60x40x8	2,400	200	112	44	34	250	144

## Live Green Meet Green!

- Hotel is within walking distance to over 60 restaurants, day spas, shopping, historical sites, activities, galleries and other entertainment.
- We donate opened shampoos, conditioners and lotions to local shelters.
- We recycle cell phones, batteries, eye glasses and toner cartridges
- Stained linen (tablecloths, napkins, towels, etc) are recycled into cleaning towels.
- Glasses and biodegradable coffee cups are provided in guest rooms.
- Glass is used on guest rooms for in-room beverages with paper doilies instead of plastic and coffee cups are made of recycled paper.
- We actively recycle (in heart of the house operations) paper, newspaper, glass, aluminum, cardboard and plastic
- Buy food and amenities in bulk to save on fuel costs and consumption
- Heating and air in meeting rooms are computer controlled so they maintain lower energy use levels when not in use
- Use CFL florescent light bulbs in guest areas, meeting rooms and sleeping rooms
- Have replaced grass landscaping with local mulch
- Filter changes, coil cleaning, thermostat calibration, and damper adjustments are part of our ongoing maintenance plan.
- We have adopted the street in front of the hotel as part of our commitment to our local community. It is our staff's responsibility to keep it clean and beautiful.
- Linen reuse program in guest rooms
- Water service via a five-gallon water dispenser is available in meeting rooms in place of bottled water on meeting tables
- Use china and silverware in place of non-biodegradable paper or Styrofoam.
- Order locally grown food
- Purchasing recycled paper for internal and external printing needs.
- Print bulk of in-house materials in black ink only
- Special parking offered for eco-friendly cars. (Eight spaces available)

Note: donating left over food and beverages to local shelters violates local ordinances due to food safety concerns and liability associated.





RENAISSANCE.  
ASHEVILLE HOTEL

## What to do in downtown Asheville when the work is done...

At the close of your event or on another “free night” during your program, don’t forget to explore the downtown Asheville area. The following are simply suggestions of some favorites.

Leaving the hotel you will find scads of restaurants and nightlife locations to choose from. And, believe it or not, there are less than five chain restaurants in the downtown repertoire of dining options.

Following Walnut away from the hotel you will find Scully’s Dine and Drink (s) on the right (casual sports bar crossed with Irish pub with a great menu). Continuing to the intersection is Old Europe and Z Lounge (sf indoors); known for courtyard dining and unbelievable deserts and pastries, full bar and coffees. Get ready for a workout as you trek up the hill on Walnut toward Haywood Street. To the left on Rankin Avenue is a new lounge called the Vault (sf). Staying on Walnut to Haywood Street, directly ahead is the Bier Garden (s) offering a wide selection of local and imported brew and a full bar. Taking a left on Haywood Street you will find a nifty corner bar and restaurant, the Flying Frog (s upstairs and sf downstairs) consisting of sidewalk seating, street-level bar and downstairs restaurant.

If it’s early in the evening, from Haywood Street turn right on Battery Park Avenue to Page Avenue. The Grove Arcade, one of Asheville’s oldest structures recently restored to a public market, is host to Carmel’s, Sante Wine Bar, Thai Basil and many others (all outdoor s only).

Suppose you decided to follow Broadway south from Walnut heading uphill? You would pass Tressa’s (s) on the left, a historic, yet trendy jazz club. Up and over the hill you go passing Wasabi Sushi Bar and the new Green Sage Café on the corner. Keeping the monument on your left, cross Patton Avenue and notice Broadway just turned to Biltmore. (Don’t you just love Asheville roads?). Along this section you will find a bit more fun to partake. Several restaurants including the Noodle Shop, Bistro 1896, Café on the Square and many more line the streets. Next up is Temptations (s), an emerging club with entertainment and drink specials nightly. Continuing, now downhill, the New French Bar (s) is on your left, careful – the occasional evening entertainment is often loud. On your right is the ever-popular Irish pub, Hannah Flanagan’s (s). Catch an independent film on the left at the Fine Arts Theatre or grab a slice and a beer at Barley’s Taproom (sf downstairs and s upstairs) and play pool or darts upstairs (beer and wine only). Just next door is Ed Boudreaux for barbeque and sports with occasional live entertainment.

Thought you had seen all there is? Asheville attracts an amazing music scene. Be sure to take a look at the “happenings” section of the Mountain Xpress or visit them online at [www.xpress.com](http://www.xpress.com). Some favorite spots are The Orange Peel, Grey Eagle and Stella Blue.

We are always happy to make suggestions based on your goals concerning free time in downtown Asheville! Contact us direct at 828-210-3009. Maps are available at the front desk.

(sf) = Smoke Free  
(s) = Smoking